

REVI XLC Downlight, 6-inch Round Recessed Tilt

REVI-XLC-6RRT-XXX, REVI-XLC-LENS-6-RXX-XXXX

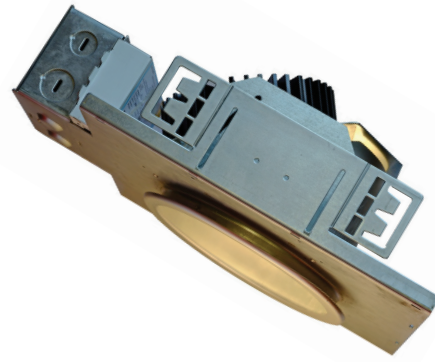

PRODUCT DESCRIPTION

Low voltage LED lighting fixtures using REVI remote driver platforms are ideally suited to improve LED illumination and reliability. Remote driver platforms are useful in difficult-to-access ceilings or architectural features. The REVI XLC downlight fixtures allow lighting designers and integrators to select from specific lumen levels, correlated color temperature, and beam distribution to configure a comprehensive lighting solution.

Ideal Application: Sloped ceilings and wall wash applications in House of Worship, Auditoriums, Gymnasiums and pendants up to 8,500+ lumens.

SYSTEM FEATURES

- Single axis adjustable chassis that tilts up to 38° to accommodate sloped ceilings or to provide wall wash and accent lighting.
- Heavy-gauge galvanized steel housing provides a secure mounting platform for the electrical components and protects the optical assembly.
- Vertically adjustable mounting brackets accept expandable hanger bars which are included.

TECHNICAL DATA

- All power leads include WAGO™ connectors for fast power connection
- Thermally protected
- See table for wattages and delivered lumens at various drive currents
- L70 = 50,000 hours at 45°C
- CRI 90+ is standard for fixtures.

REMOTE DRIVER OPTIONS

The REVI system features a remote panel that operates multiple lighting fixtures. These remote power supplies can be installed in an easy-to-access area such as a utility closet. Benefits include longer driver life due to reduced exposure to the heat of the LED engine and emergency (EM) options. Low-voltage class-2 wiring between driver panel and lighting fixture. No conduit required.

MECHANICAL SPECIFICATIONS

FRONT VIEW

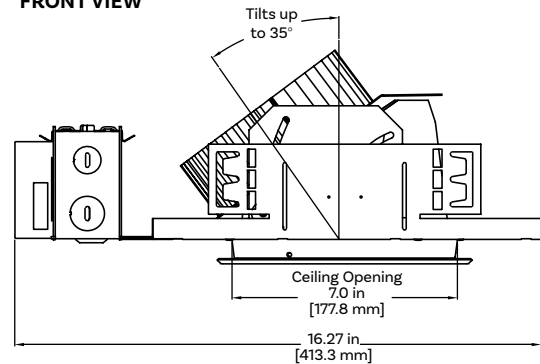

SIDE VIEW

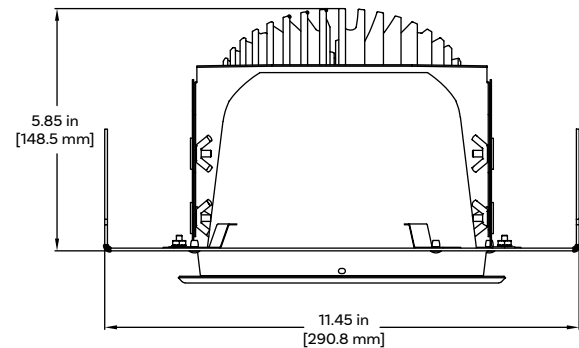

ISO VIEW

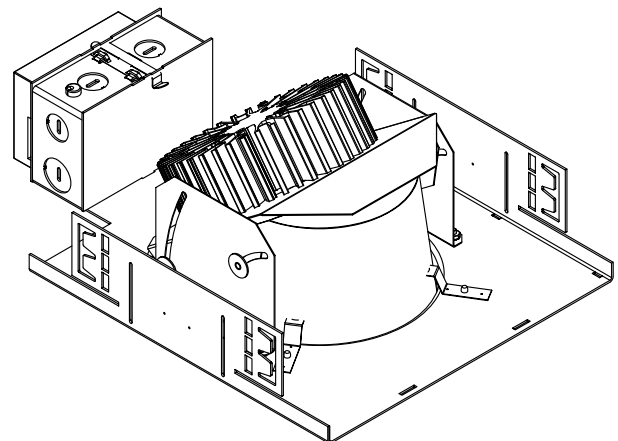

5 Year
Warranty



For More Information

888.880.1880

ContactUs@EnvironmentalLights.com
©Environmental Lights. All rights reserved.

REVI XLC Downlight, 6-inch Round Recessed Tilt

REVI-XLC-6RRT-XXX, REVI-XLC-LENS-6-RXX-XXXX

ASSEMBLY BUILDER

FIXTURE SKU BUILDER

Example: REVI-XLC-6RRT-35K = REVI XLC Downlight 6-inch Round Recessed Tilt, 3500K Color Temperature

REVI-XLC-6RRA

Fixture Series

Color Temperature

35K = 3500K

30K = 3000K

LENS SKU BUILDER

Example: REVI-XLC-LENS-6-RCG-WL = REVI XLC Downlight 6-inch Round Recessed Adjustable, Clear Tempered Glass Lens, Wet Location

REVI-XLC-LENS-6

Trim Series

Lens

Flange

Open (No Lens) - LEAVE BLANK

SCLPF = Soft Spec Clear Reflector w/ Polished Flange***

RCG = Clear Tempered Glass Lens

SCL = Soft Spec Clear Reflector w/ Matte White Flange***

RCA = Clear Acrylic Lens

HAZPF = Haze Alzak Reflector w/ Polished Flange***

RPA = Prismatic Acrylic Lens

HAZ = Haze Alzak Reflector w/ Matte White Flange***

RND = Narrow Lens

MWH = Matte White Reflector w/ Matte White Flange***

RMD = Medium Lens

WL = Wet Location

RWD = Wide Lens

DELIVERED LUMEN FOR LOW-OUTPUT DRIVER SETTINGS

Type	Model	Input Current (mA)	Nominal Power (W)	Lumens	Beam Angle	Lumens/W
Tilt	REVI-XLC-6RRT-35K	2100	80	8500	70°	115

Scaling factors for other color temperatures: 3000K = 0.97

Scaling factor for 90 CRI=0.83

*Can be driven with REVI-Drive-12-250W - Only 9 fixtures total (3 fixtures per bank of 4 channel outputs)

Typical Layout for Low Voltage LED Lighting Fixtures with Remote Driver Platform

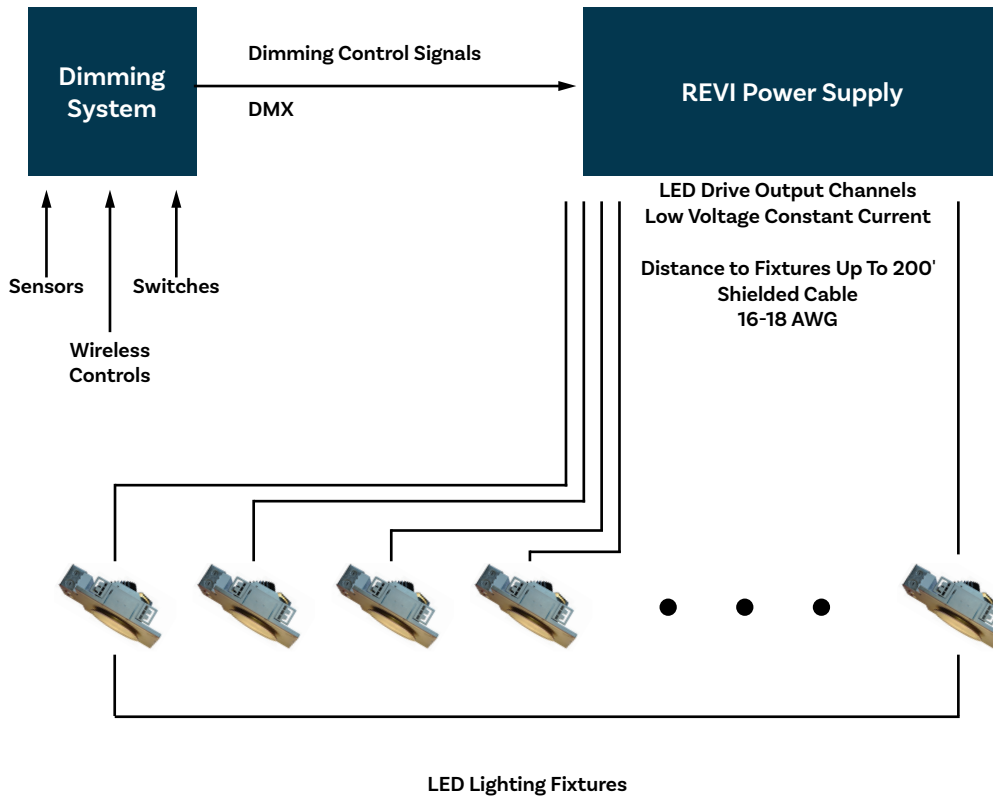

MOUNTING KITS & ACCESSORIES



REVI XL Thread Adapter, M10 to 3/8 IPS

REVI-XL-adapter-M10-38ips

This M10 to 3/8 IPS adapter is included with each REVI-XLC Light Engine. The XL Thread Adapter facilitates simple connection to certain REVI XL Stem and Cable Mounts. This product is not sold separately.

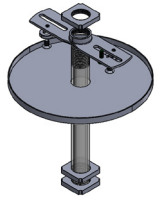
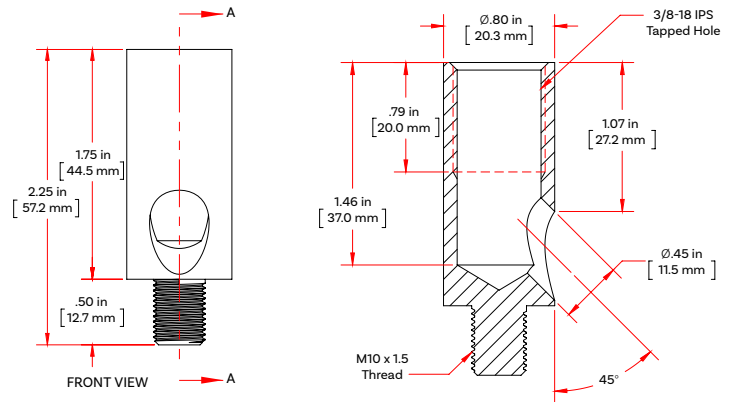

REVI XL Canopy for Stem or Surface Mount Fixed, Black Finish

REVI-XL-M-canopy-fixed-38ips-B

An architectural-grade fixed canopy designed to assist in mounting REVI XL downlight fixtures.

For a polished look that expedites installation, magnets are utilized to secure the canopy.

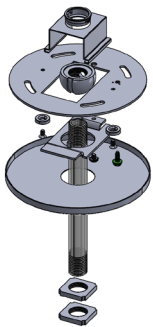
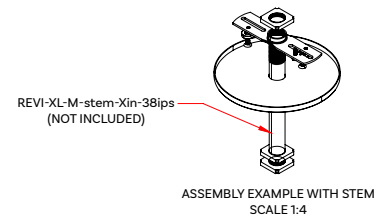
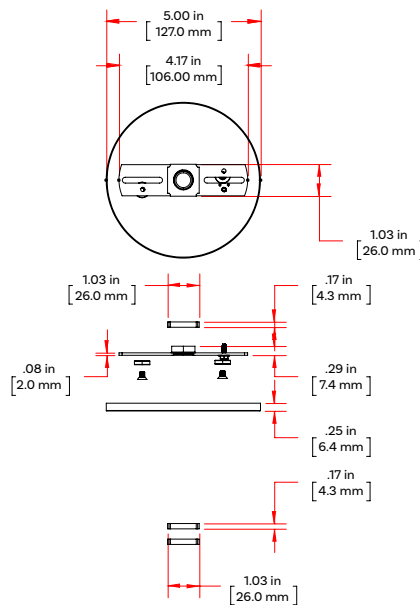

REVI XL Canopy for Stem or Surface Mount Swivel, Black Finish

REVI-XL-M-canopy-swivel-38ips-B

An architectural-grade swivel canopy designed to assist in mounting REVI XL downlight fixtures. The swivel feature enables it to be used for sloped ceilings up to 38 degrees.

For a polished look that expedites installation, magnets are utilized to secure the canopy.

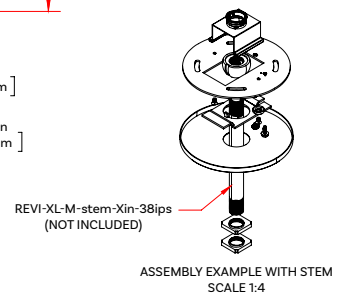
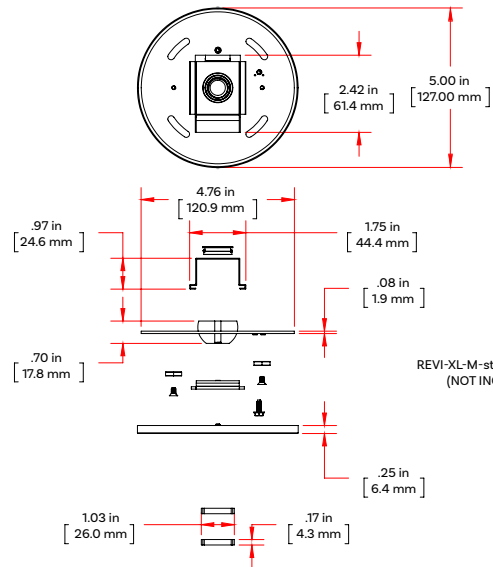

MOUNTING KITS & ACCESSORIES



REVI XL Stem - Surface Mount
3/8 IPS - Black Finish
REVI-XL-M-stem-S-38ips-B

A miniature 1-inch stem for use with REVI XL downlight fixtures. Must be utilized with one of the REVI XL Canopy Kits.

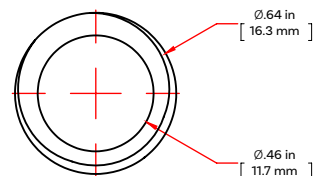
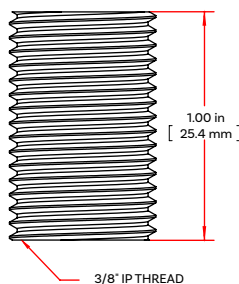

REVI XL Stem - 3/8 IPS - Black Finish
REVI-XL-M-stem-24in-38ips-B
REVI-XL-M-stem-36in-38ips-B
REVI-XL-M-stem-48in-38ips-B

An architectural grade available in 24-inch, 36-inch and 48-inch stems used for mounting REVI XL downlight fixtures.

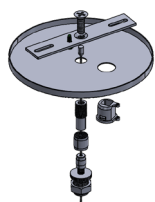
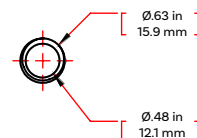
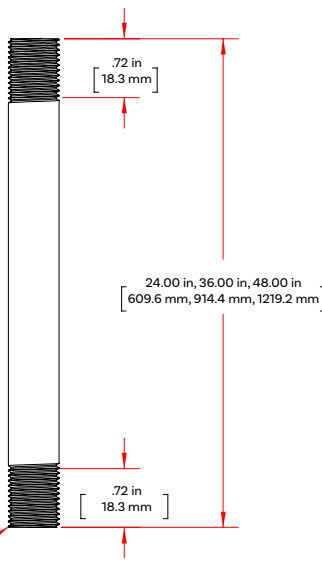

REVI XL Cable Mount Canopy Kit
10-foot Cable - 3/8 IPS Gripper,
Black Finish
REVI-XL-M-canopy-cable-10ft-38ips-B

An architectural-grade cable mounting kit for mounting REVI XL downlight fixtures. A 10-foot cable and 3/8 IPS gripper are included in this package. The kit facilitates simple height adjustments at the fixture using the included hardware.

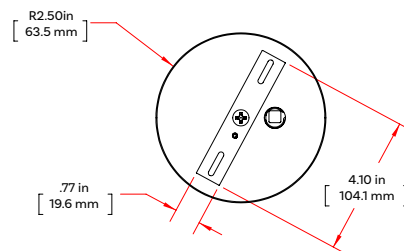
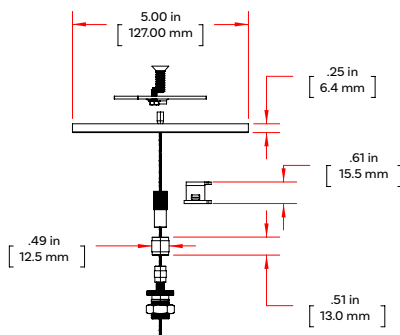

MOUNTING KITS & ACCESSORIES



REVI XL Cable Mount - 10-foot Cable w/ Loop

REVI-XL-M-cable-10ft

A 1/16" aircraft cable with a 1" loop used for mounting REVI XL downlight fixtures. Can be used as the primary mounting accessory or secondary safety cable.

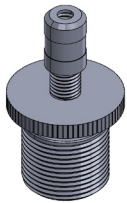
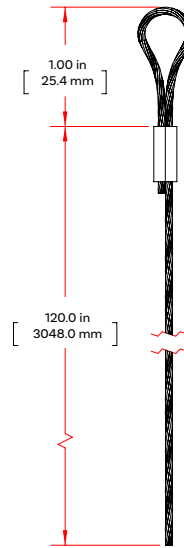

REVI XL Cable Mount - 3/8 IPS Gripper

REVI-XL-M-grip-38ips

A 3/8 IPS gripper accessory for cable mounting REVI XL downlight fixtures. The gripper assists in adjusting the height of fixtures.

