

## EcoFlex 4-in-1 LED Neon - Vertical Bend

LN-ECO-VB-RGB3000K, LN-ECO-VB-RGB6500K, LN-ECO-VB-RGBA

### PRODUCT DESCRIPTION

EcoFlex 4-in-1, RGB + [3000K/6500K/Amber] LED Neon is a highly flexible and cost-effective LED Neon product that expands your neon color mixing possibilities by combining 3000K/6500K/Amber and RGB. This neon allows you to achieve the creative potential of traditional glass neon while getting all the benefits of LED. This is the “vertical bend” version, which means it bends like standard strip light, but provides the diffused look of neon. It can be used to wrap around three-dimensional objects like columns, with the light shining outward.

EcoFlex LED Neon is UL Listed and saves time and money on installation. It runs on 24 volts DC and its silicone casing provides protection and excellent diffusion for a hotspot-free appearance. EcoFlex LED Neon is incredibly flexible, with a 40mm minimum vertical bending radius. It is low maintenance and easy to control. This product comes with leads on each end so it can be cut and capped if needed. It is ideal for use in retail, scenic, architectural and other decorative lighting installations.

### TECHNICAL SPECIFICATIONS

Product	LN-ECO-VB-RGB3000K-10m, LN-ECO-VB-RGB3000K-5m	LN-ECO-VB-RGB6500K-10m, LN-ECO-VB-RGB6500K-5m	LN-ECO-VB-RGBA-10m, LN-ECO-VB-RGBA-5m
Color Detail	RGB + 3000K	RGB + 6500K	RGB + Amber
Wave Length	630/520/463	630/520/463	630/520/463
Power (Watts/meter)	9.6 Watts/m	9.6 Watts/m	9.6 Watts/m
Power (Watts/ft)	2.9 Watts/ft	2.9 Watts/ft	2.9 Watts/ft
Brightness (lm/meter)	41/136/29/127 lumens/meter	41/136/29/127 lumens/meter	41/136/29/39 lumens/meter
Beam Angle	120°	120°	120°
Width	0.63 in (16 mm)	0.63 in (16 mm)	0.63 in (16 mm)
Length	32.81 ft (10 m), 16.4 ft (5 m)	32.81 ft (10 m), 16.4 ft (5 m)	32.81 ft (10 m), 16.4 ft (5 m)
Min. Cutting Increment	2.46 in (62.5 mm)	2.46 in (62.5 mm)	2.46 in (62.5 mm)
LED Density	96 LEDs/meter	96 LEDs/meter	96 LEDs/meter
LED Spacing	0.41 in (10.42 mm)	0.41 in (10.42 mm)	0.41 in (10.42 mm)
IP Rating	IP65	IP65	IP65

### MECHANICAL SPECIFICATIONS

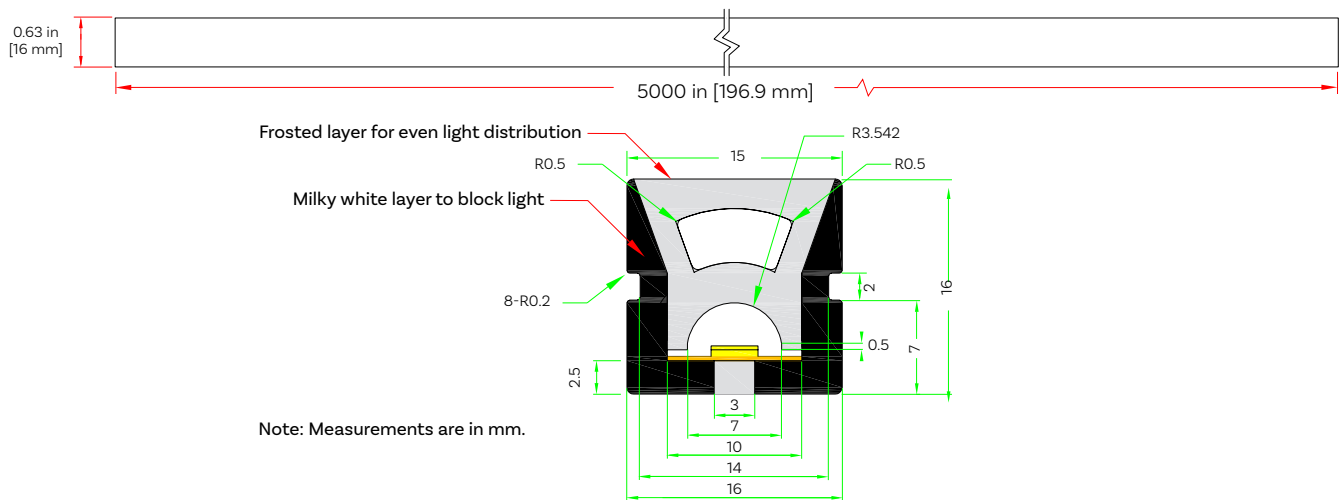

### PRODUCT FEATURES

- Flexible silicone housing
- UV resistant and low maintenance
- Bends vertically (opposite direction of our standard Neon product lines)
- 4-in-1 [RGB + 3000K, 6500K or Amber]
- Both 5 and 10-meter reel lengths
- 1-meter injection molded leads on BOTH ends of each reel
- Average Lifetime: 50,000 Hours

### REGULATORY

- UL Listed
- RoHS
- Average Lifetime: 50,000 hours
- Warranty: 5 Year Limited

## PRODUCT CONNECTORS & MOUNTING PROFILES

### A END CONNECTORS

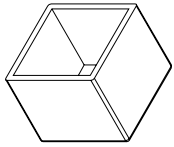

#### End Cap LN-ECO-EC

End Cap accessory is compatible with EcoFlex 4-in-1 Vertical Bend LED Neon. Glue is sold separately. Please note user installation of end caps will void factory IP rating of EcoFlex 4-in-1 LED neon. Consult installation instructions for best practices.

#### FRONT

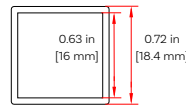

#### TOP

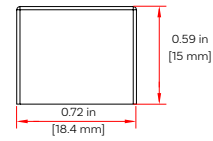

#### CROSS-SECTION

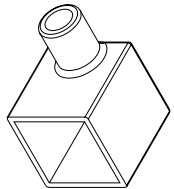
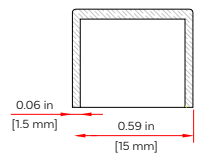

#### End Cap with Wire Exit LN-ECO-VB-R4

End cap with front wire exit is compatible with EcoFlex 4-in-1 Vertical Bend LED Neon. End cap with wire exit includes 1-meter leads. Glue is sold separately. Please note user installation of end caps will void factory IP rating of EcoFlex 4-in-1 LED neon. Consult installation instructions for best practices.

#### FRONT

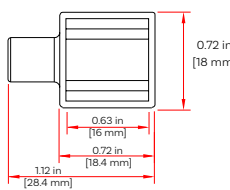

#### TOP

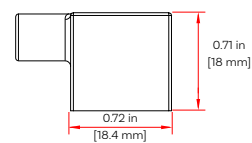

#### CROSS-SECTION

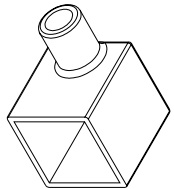
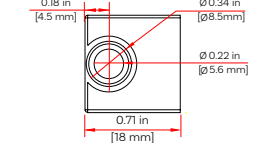

#### End Cap with Back Wire Exit LN-ECO-VB-S4

End cap with back wire exit is compatible with EcoFlex 4-in-1 Vertical Bend LED Neon. End cap with wire exit includes 1-meter leads. Based on positioning of the cap, this can be used for right or left side wire exit. Glue is sold separately. Please note user installation of end caps will void factory IP rating of EcoFlex 4-in-1 LED neon. Consult installation instructions for best practices.

#### FRONT

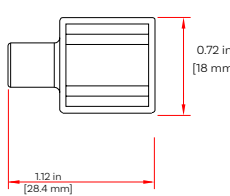

#### TOP

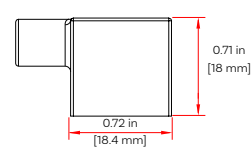

#### CROSS-SECTION

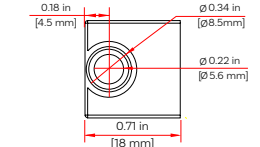

### B MOUNTING PROFILE

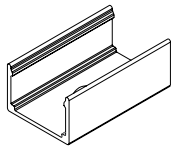

#### Mounting Clip LN-ECO-VB-CLIP

Used for mounting EcoFlex 4-in-1 LED Neon - Vertical Bend and holding it in place. Screw sold separately.

#### FRONT

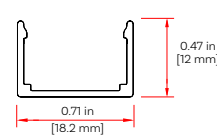

#### TOP

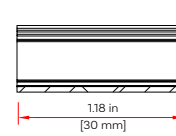

#### BOTTOM

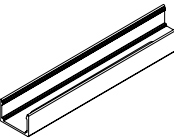
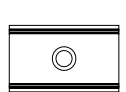

#### Mounting Channel LN-ECO-VB-ACH-2m

Aluminum channel designed for mounting EcoFlex 4-in-1 LED Neon - Vertical Bend and holding it in place.

#### FRONT

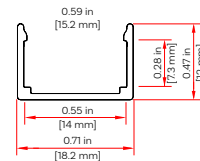

#### TOP



Note: Measurements are in mm.