

LED Adapters with Dimming Knobs

EL-Adapter-60-12D-NA, EL-Adapter-96-24D-NA



PRODUCT DESCRIPTION

These high quality 12 VDC and 24 VDC adapters with a dimming knob suitable for powering LED lighting. They feature a built-in North American Plug on one end and two Male Barrel Connectors on the other. The housing is coated in a sleek, professional black finish.

These adapters accept 100 to 240 VAC input and feature protections for short circuit, overload, and over voltage. They are ideal for quick and easy dimming (tradeshows, store displays, restaurants) and set-it-and-forget-it permanent installations (coves, soffits in hotels, casinos).

PRODUCT FEATURES

- UL Listed - Class 2 power supply
- Designed for 100% load
- PWM frequency, varies from 20,000Hz to 800Hz
- Protections: Short circuit / Overload / Over voltage
- Low ripple noise
- Rugged metal housing
- Sleek black finish

MECHANICAL SPECIFICATIONS

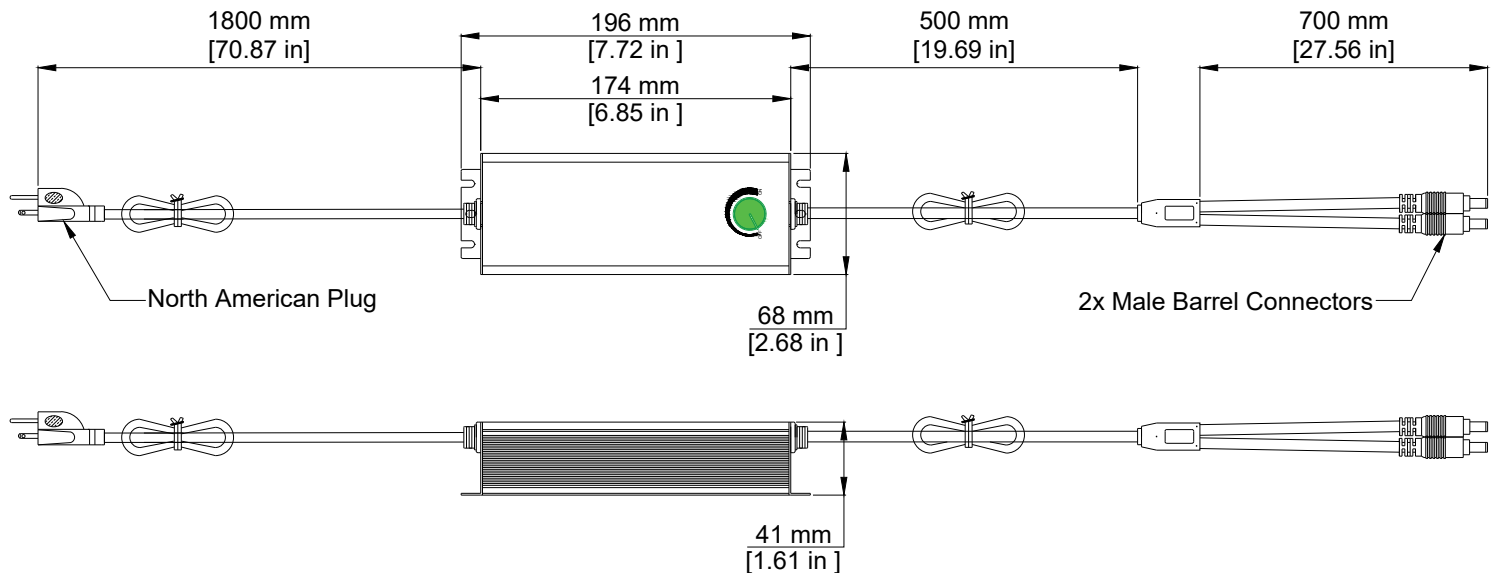

TECHNICAL SPECIFICATIONS

Product Number	EL-Adapter-60-12D-NA	EL-Adapter-96-24D-NA
Dimensions	7.72" x 2.68" x 1.61"	7.72" x 2.68" x 1.61"
Dimming	Built-In	Built-In
Finish	Black	Black
Input Current	1300 mA	2500 mA
IP Rating	IP20	IP20
Output Current	5000mA	4000mA
Output Voltage	12 DC	24 DC
Power	60 Watts	96 Watts
Regulatory	UL Listed, FCC, RoHS	UL Listed, FCC, RoHS
Voltage	100 to 240 AC	100 to 240 AC
Warranty	1 Year	1 Year

LED Drivers with Dimming Knobs

EL-Driver-60-12D-NA, EL-Driver-96-24D-NA



PRODUCT DESCRIPTION

Use these 60-Watt (12 VDC) and 96-Watt (24 VDC) full capacity Driver between your 100 to 240 VAC input and your LED lights to achieve smooth dimming with the built-in dimming knob. It comes in a sleek, professional black finish.

These drivers are quick and easy to wire. Three input wires run from the 100-240VAC circuit on the primary side and two output wires run from the secondary side for the load.

PRODUCT FEATURES

- UL Listed - Class 2 power supply
- Designed for 100% load
- PWM frequency, varies from 20,000Hz to 800Hz
- Protections: Short circuit / Overload / Over voltage
- Low ripple noise
- Rugged metal housing
- Sleek black finish

MECHANICAL SPECIFICATIONS

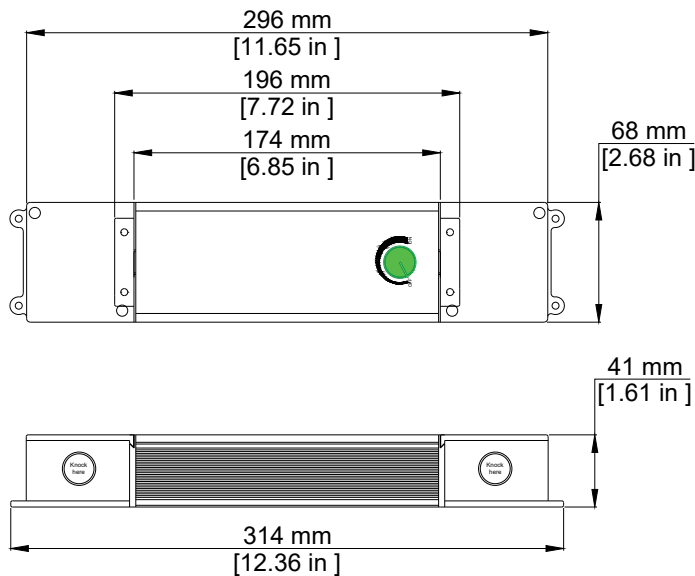

TECHNICAL SPECIFICATIONS

Product Number	EL-Driver-60-12D-NA	EL-Driver-96-24D-NA
Dimensions	12.36" x 2.68" x 1.61"	12.36" x 2.68" x 1.61"
Dimming	Built-In	Built-In
Finish	Black	Black
Input Current	1300 mA	2500 mA
IP Rating	IP20	IP20
Output Current	5000mA	4000mA
Output Voltage	12 DC	24 DC
Power	60 Watts	96 Watts
Regulatory	UL Listed, FCC, RoHS	UL Listed, FCC, RoHS
Voltage	100 to 240 AC	100 to 240 AC
Warranty	1 Year	1 Year